

ROUTE 19 GRANADA

EFFECTIVE: 01/24/10

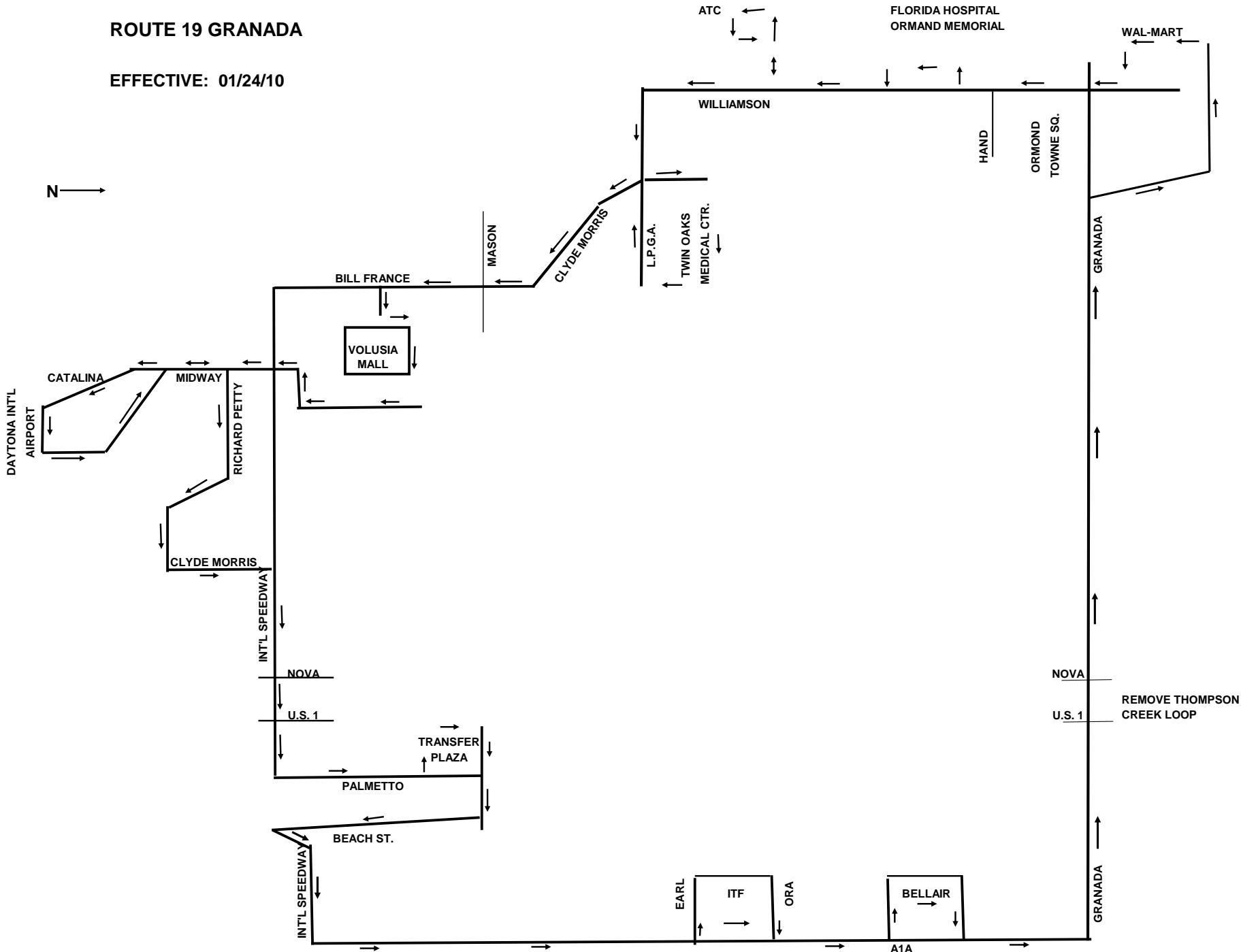

- All times shown in **bold** are p.m. trips.
- All trips shown in **blue** do not operate on Saturdays.
- **(E)** Indicates end of schedule.

Trips shaded in **blue** or **green** do not operate on Memorial Day, July 4th and Labor Day.

No service on Thanksgiving Day, Christmas and New Years Day.

SCHEDULE IS SUBJECT TO CHANGE WITHOUT NOTICE

19 Granada

Departs Gate S-7 Outbound to Florida Hospital/Ormond Memorial via A1A/Granada

Transfer Plaza	Intermodal Transit Facility	Bellaïr Plaza	Granada/Halifax	Granada/U.S. 1	Granada/Nova	Walmart/Ormond Beach
6:07	6:16	6:25	6:34	6:39	6:44	6:52
7:02	7:12	7:22	7:32	7:37	7:42	7:50
8:02	8:12	8:22	8:32	8:37	8:42	8:50
9:02	9:12	9:22	9:32	9:37	9:42	9:50
10:02	10:12	10:22	10:32	10:37	10:42	10:50
11:02	11:12	11:22	11:32	11:37	11:42	11:50
12:02	12:12	12:22	12:32	12:37	12:42	12:50
1:02	1:12	1:22	1:32	1:37	1:42	1:50
2:02	2:12	2:22	2:32	2:37	2:42	2:50
3:02	3:12	3:22	3:32	3:37	3:42	3:50
4:02	4:12	4:22	4:32	4:37	4:42	4:50
5:02	5:12	5:22	5:32	5:37	5:42	5:50
6:02	6:11	6:20	6:29	(E)6:34	-:-	-:-

Arrives Gate S-7 Inbound to Transfer Plaza via Int'l Speedway

Walmart/Ormond Beach	Florida Hospital/Ormond Memorial	Advanced Technology Ctr.	Twin Lakes Medical Center	Volusia Mall/J.C. Penney-Rear	Daytona Int'l Airport	Richard Petty/Clyde Morris	Int'l Speedway/Nova	Transfer Plaza
7:02	7:10	7:14	7:19	7:30	7:38	7:42	7:47	7:58
8:02	8:10	8:14	8:19	8:30	8:38	8:42	8:47	8:58
9:02	9:10	9:14	9:19	9:30	9:38	9:42	9:47	9:58
10:02	10:10	10:14	10:19	10:30	10:38	10:42	10:47	10:58
11:02	11:10	11:14	11:19	11:30	11:38	11:42	11:47	11:58
12:02	12:10	12:14	12:19	12:30	12:38	12:42	12:47	12:58
1:02	1:10	1:14	1:19	1:30	1:38	1:42	1:47	1:58
2:02	2:10	2:14	2:19	2:30	2:38	2:42	2:47	2:58
3:02	3:10	3:14	3:19	3:30	3:38	3:42	3:47	3:58
4:02	4:10	4:14	4:19	4:30	4:38	4:42	4:47	4:58
5:02	5:10	5:14	5:19	5:30	5:38	5:42	5:47	5:58
5:57	6:05	6:09	6:14	6:24	6:32	6:36	6:41	(E)6:50

* At 6:50 p.m. this trip will go to the Intermodal Transit Facility and begin night service.

* El viaje de las 6:50 p.m.