

ROUTE 18 GRANADA

EFFECTIVE: 01/24/10

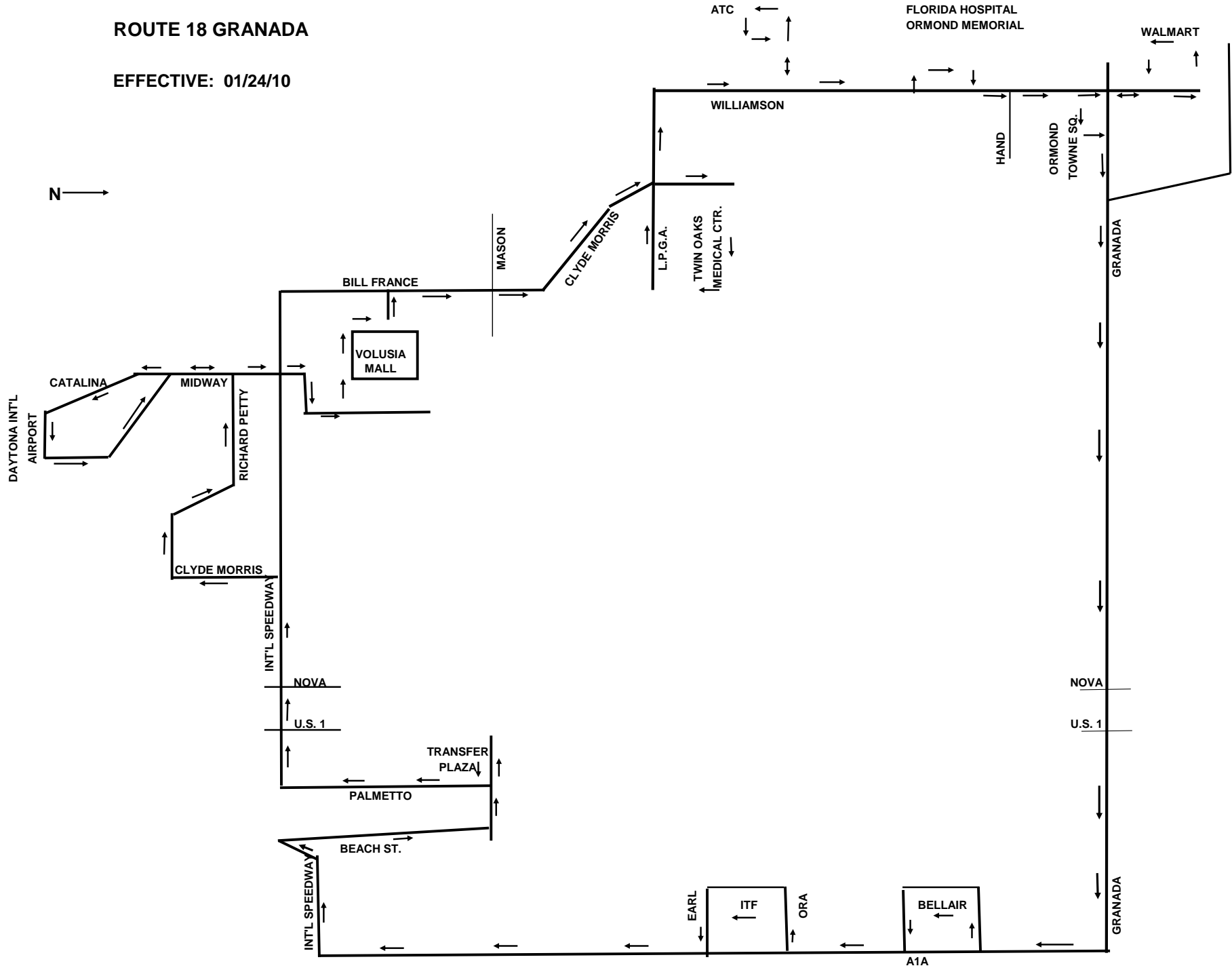

- All times shown in **bold** are p.m. trips.
- All trips shown in **blue** do not operate on Saturdays.
- **(E)** Indicates end of schedule.

Trips shaded in **blue** or **green** do not operate on Memorial Day, July 4th and Labor Day.

No service on Thanksgiving Day, Christmas and New Years Day.

SCHEDULE IS SUBJECT TO CHANGE WITHOUT NOTICE

18 International Speedway

Departs Gate N-3 Outbound to Florida Hospital/Ormond Memorial via Int'l Speedway/Williamson

Transfer Plaza	International Speedway/ Nova	Richard Petty/ Clyde Morris	Daytona Beach Int'l Airport	Volusia Mall Main Entrance	Twin Lakes Medical Center	Advanced Technology Ctr.	Florida Hospital/ Ormond Memorial	Walmart/ Ormond Beach
7:02	7:09	7:14	7:19	7:25	7:34	7:40	7:45	7:51
8:02	8:09	8:14	8:19	8:25	8:34	8:40	8:45	8:51
9:02	9:09	9:14	9:19	9:25	9:34	9:40	9:45	9:51
10:02	10:09	10:14	10:19	10:25	10:34	10:40	10:45	10:51
11:02	11:09	11:14	11:19	11:25	11:34	11:40	11:45	11:51
12:02	12:09	12:14	12:19	12:25	12:34	12:40	12:45	12:51
1:02	1:09	1:14	1:19	1:25	1:34	1:40	1:45	1:51
2:02	2:09	2:14	2:19	2:25	2:34	2:40	2:45	2:51
3:02	3:09	3:14	3:19	3:25	3:34	3:40	3:45	3:51
4:02	4:09	4:14	4:19	4:25	4:34	4:40	4:45	4:51
5:02	5:09	5:14	5:19	5:25	5:34	5:40	5:45	5:51
6:02	6:09	6:14	6:19	(E)6:25	--	--	--	--

Arrives Gate N-3 Inbound to Transfer Plaza via A1A

Walmart/ Ormond Beach	Ormond Towne Square	Granada/ Nova	Granada/ U.S. 1	Granada/ A1A	Bellair Plaza	Intermodal Transit Facility	Transfer Plaza
--	--	--	6:20	6:25	6:35	6:45	6:58
6:56	7:01	7:08	7:13	7:18	7:30	7:42	7:58
7:56	8:01	8:08	8:13	8:18	8:30	8:42	8:58
8:56	9:01	9:08	9:13	9:18	9:30	9:42	9:58
9:56	10:01	10:08	10:13	10:18	10:30	10:42	10:58
10:56	11:01	11:08	11:13	11:18	11:30	11:42	11:58
11:56	12:01	12:08	12:13	12:18	12:30	12:42	12:58
12:56	1:01	1:08	1:13	1:18	1:30	1:42	1:58
1:56	2:01	2:08	2:13	2:18	2:30	2:42	2:58
2:56	3:01	3:08	3:13	3:18	3:30	3:42	3:58
3:56	4:01	4:08	4:13	4:18	4:30	4:42	4:58
4:56	5:01	5:08	5:13	5:18	5:30	5:42	5:58
5:56	6:01	6:08	6:13	6:17	6:28	6:38	(E)6:50

ON HOLIDAYS, ROUTE 18 ENDS AT VOLUSIA MALL.

EL DÍAS DE FIESTA, RUTA 18 EXTREMOS DE VOLUSA MALL